

CONCRETE FLOOR OR WALL CABLE TRAY

F Rating 2 Hr.

T Rating 1/2 Hr.

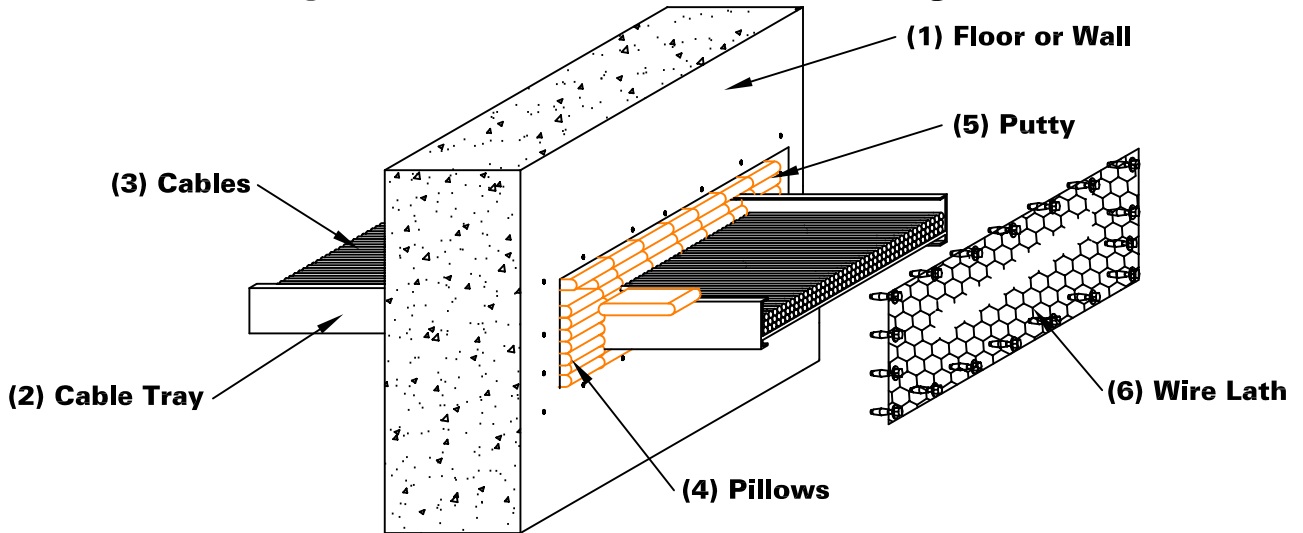

1. FLOOR or WALL ASSEMBLY - Min. 4-1/2" (114mm) thick lightweight or normal weight concrete floor or wall, or CMU block wall. Max. area of opening is 189 sq. in. (1219 sq. cm) with max. dimension of 27" (686mm).
2. CABLE TRAY - Max. 24" (610mm) wide x 4" (102mm) deep steel or aluminum, open ladder type cable tray. Annular space between side rails of cable tray and periphery of opening shall be 1-1/2" (38mm). Annular space between the back of cable tray and periphery of opening may range from 0" (point of contact) to 2-3/4" (70mm).
3. CABLES - Max. 40% cable fill of opening in any combination of:
 - (A) max. 1/C #300 kcmil cable w/cross linked polyethylene (XLPE) jacket.
 - (B) max. 7/C #12 awg cable w/polyvinyl chloride (PVC) or (XLPE) insulation and PVC jacket.
 - (C) max. 100pr #24 awg cable w/PVC insulation and PVC jacket.
4. NELSON PLW PILLOWS (part # AA478 or AA479) - Pillows to be installed horizontally within the opening in such a manner that the ends project beyond each surface of floor or wall. Pillows tightly packed into opening to fill the annular space between cables and periphery of opening and between cable tray and periphery of opening.
5. NELSON FSP PUTTY (part # AA445) - At the point of contact location between the cable tray and concrete, a min. 1" (25mm) bead of putty shall be hand packed at concrete/cable tray interface on top surface of floor and on both surfaces of wall.
6. WIRE LATH - Nominal 2" (51mm), 19awg. galv. steel wire lath, cut to fit the contour of the opening with a min 3" (76mm) lap beyond the periphery of the opening. Wire lath secured to top surface of floor and both surfaces of wall assembly with 1/4" (6mm) diameter by 1" (25mm) long concrete anchors in conjunction with 1/4" (6mm) by 1-1/2" (38mm) diameter steel fender washers, spaced 8" (203mm) OC.

Tested in accordance with:

ASTM E-814
ANSI/UL 1479



**System No.
C-AJ-4013**

Nelson Firestop

DWG NO. FS-0100 R5

DATE: 07/14/06

BY: RL

MEA # 196-84-M Vol.3

Nelson Firestop

800 331-7325 Fax: 918 627-2941

Tulsa, Ok.

Project Name: _____
Address: _____
Installer: _____
Address: _____
Signature: _____